

CANOPY SOUTH

EXISTING INFRASTRUCTURE EVALUATION

EXISTING UTILITY INFORMATION GATHERING

COMBINED SEWER

City of Omaha

TELECOMMUNICATIONS

Cox Communications

CenturyLink

GAS & WATER

Metropolitan Utilities District

POWER

Omaha Public Power District

CELLULAR

Summit Media

1. Streets to remain in place will be repaved with new right-of-way dedicated as necessary. Combined lines would not need to be re-routed. Is separation required?

[aw 3/29/21] Separation of sewers is likely not required just to repave a street, however we will require a review of the sewer condition by using CCTV to identify any condition issues that need to be addressed before a new street is constructed.

JLK-AGREE WITH ADAM

JMM-The City has very little CCTV. What is TV'd has 4 and 5 rated defects (highest types like hole void visible). There is a history of pipe repairs in the area. Three related to cave-ins due to rated 3 defects (offset joints). So likelihood of poor condition sewers has higher probability. No chronic wet-weather basement backups or overflows. 20th and W does have a history of manhole covers off during wet weather.

2. Some streets will be vacated and re dedicated along a new alignment. Can combined sewer be re-routed or does it need to be separated?

[aw 3/29/21] Per Title 123, construction of new combined sewers is prohibited. If new sewer is being constructed, it should be separate storm and sanitary sewer.

JLK-AGREE WITH ADAM

JMM-I would add that pipelines classified as "sanitary-combined" need to be treated as sanitary and if no storm sewers connected, could potentially be re-routed as sanitary that then tie into the combined sewer system. No new stormwater flow may be added to a sanitary system per State statute, this includes the combined wastewater collection system.

<http://deq.ne.gov/RuleAndR.nsf/RuleAndReg.xsp?documentId=5E566872CE69F9FB06256BB900544BC1&action=openDocument>

3. Several of the existing combined lines only serve the existing apartments. These lines will likely be removed and replaced with separate storm and sanitary infrastructure. Are there any guidelines for where these can tap combined sewer?

[aw 3/29/21] Yes, this will need to be coordinated with the City. It appears that there has been past sewer separation in the area, and that some combined sewer lines are primarily for stormwater, and some are primarily for sanitary sewage.

JLK-WE SHOULD ALSO LOOK AT OPPORTUNITIES TO SEPARATE IF AT ALL POSSIBLE DUE TO THE OTHER NEW CONSTRUCTION OF SEPARATION LINES IN THE SUBDIVISION.

JMM- If it only serves one parcel, recommended releasing ownership. Sewer maintenance looks at combined sewer connections on a case by case to make sure development is tapping the correct pipelines. As Adam mentioned, some pipes are now clearly acting more like storm-only, where several pipes are and should be sanitary only; especially the smaller diameter pipes. WCSDM requires a manhole condition assessment as part of connection request.

4. The site will see some significant re-grading. Are there any requirements for how much fill can be placed over a combined line to remain in place? Is there a minimum cover requirement?

[aw 3/29/21] I don't know of any hard rules on this, but it will come down to the structural integrity of the sewer lines, and we will look to the engineer to show that the sewers can handle the dead and live loads under the proposed grading. If the existing sewers cannot handle the modified grades, steps will need to be taken to replace or modify the sewers so that they can.

JLK-AGREE WITH ADAM.

JMM-WCSDM 4.4 Depth of Public Sewer: (paraphrased) ... "sufficiently deep" to provide service and prevent freezing. Min depth of 5ft of cover. Sewer Maintenance may require new barrels section if excessively deep. Also Standard Plate states that manholes greater than 20' in depth shall be designed by a PE. City will also have to make sure there are adequate easement widths based on depth. TV assessment will be required prior to allowing fill to understand risk.

Sewer Risk

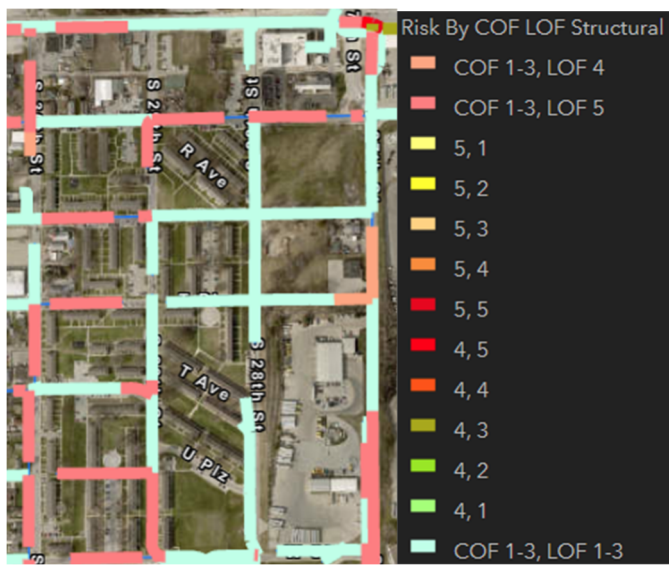

Consequence of failure (Location, Street type, depth, volume served, etc)

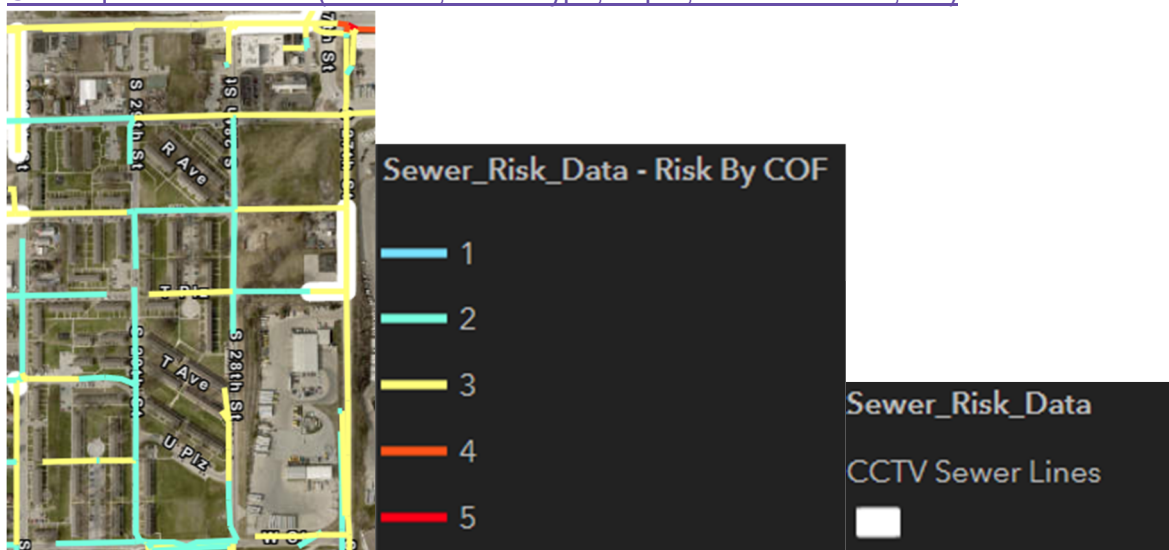

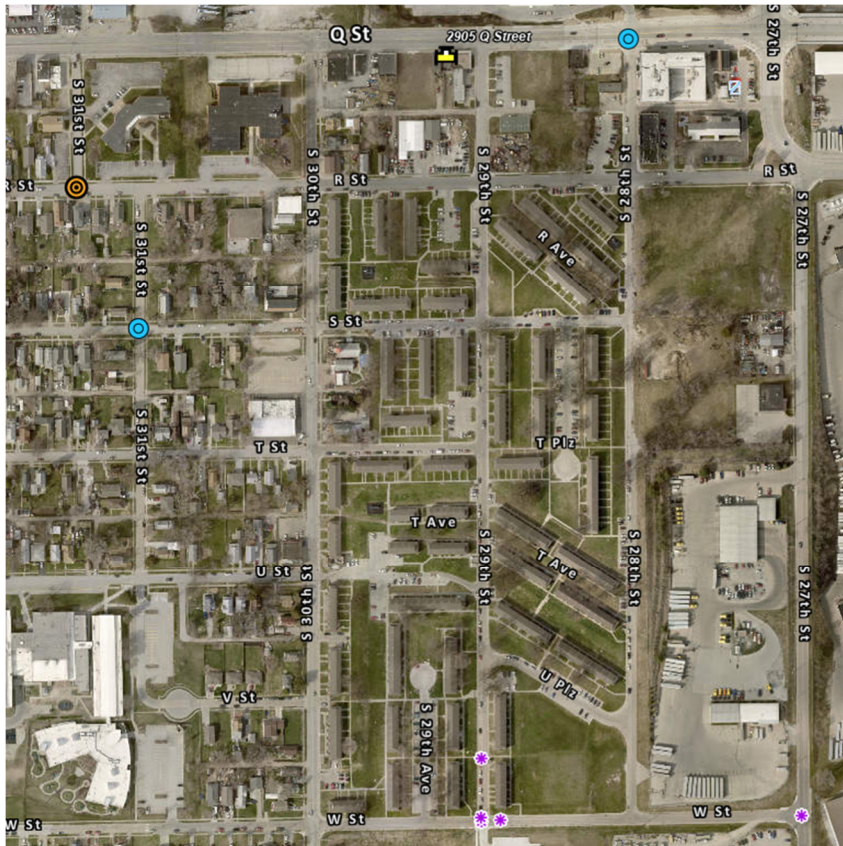

SSO CSO All Causes >

- Unable to Confirm; Private Issue
- ◆ Construction/Utility/Contr.Damaged/Beyond City Control/Mechanical Malfunction/Power Failure
- Illicit Connection; Entity Overloaded
- + Vandalism; Other; Blockage
- Unknown
 - ↓ Construction Debris
 - Debris
 - Grease
 - × Line Collapse
 - ⊗ Line Defect
 - ✱ Rags
 - Roots
 - Sewer Overload
 - ⚡ Water Main Break
 - Grit
 - <all other values>

Wet Weather Incidents 2014- Present

- ✱ Flooded Property
- ✱ Missing MH Cover
- ✱ Other
- ✱ Sewer Backup - CSS
- ✱ Sewer Backup - SSS
- ✱ Sewer Overflow - CSS
- ✱ Sewer Overflow - SSS
- ✱ <all other values>

Backflow Preventers

- 67634
- 7140
- 7150
- Other (State in comments)
- <all other values>

(SCK 3/30/21)From the stormwater management perspective, it will be helpful if I know what direction Lamp gets from Design and Sewer Maintenance beforehand. That way, I can make sure they don't increase runoff to a system without capacity.

There is also an existing BMP at the parking lot for the Stephens Center (NW Corner of 28th St and R). If there are changes that include this area, the capacity of the BMP will need to be maintained and if changes occur, the maintenance agreement will need to be updated.

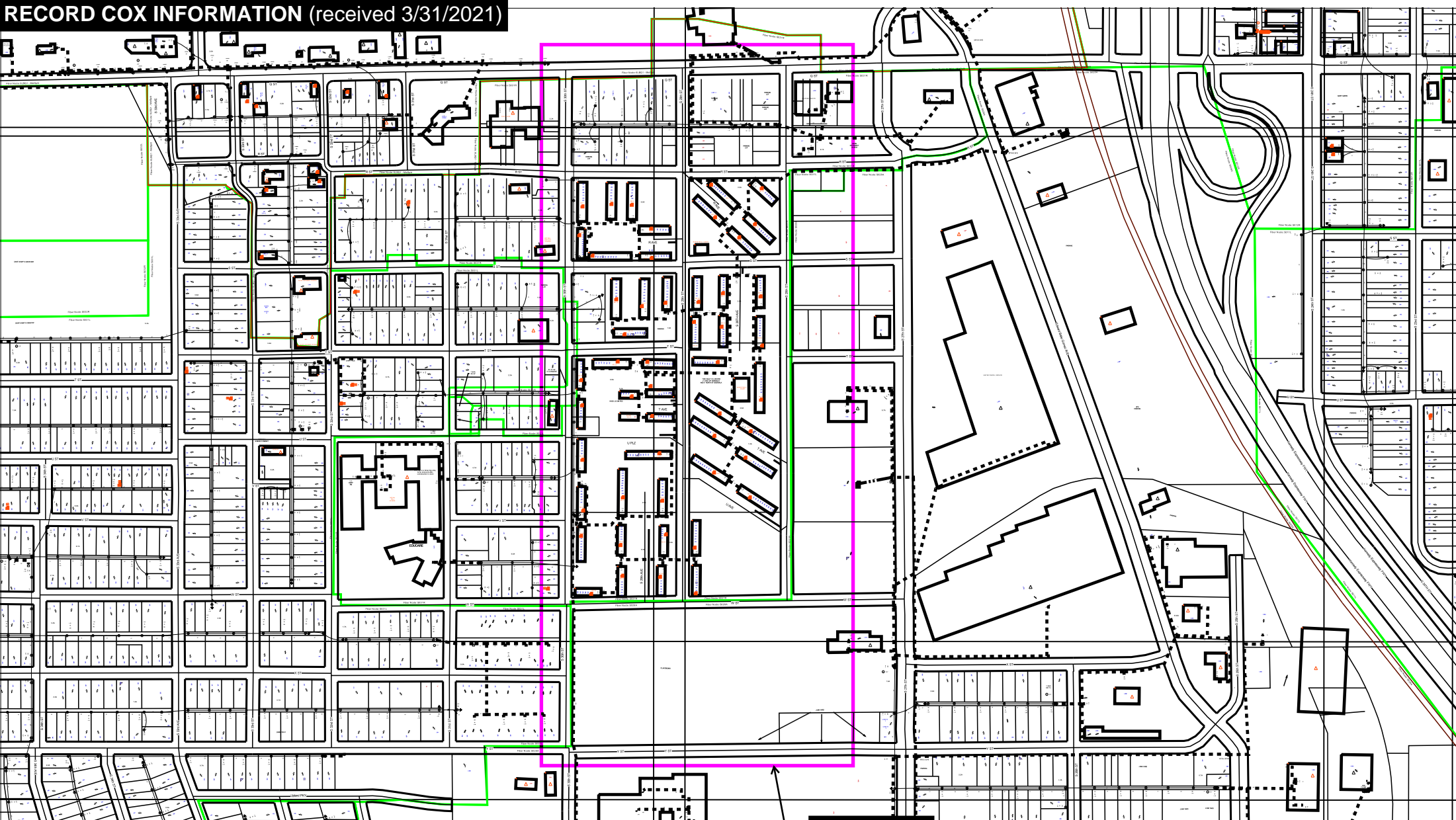

PROJECT LOCATION

Map Legend:

Pedestal		Underground Structure	
Vault		Overhead Structure	
Riser			
Pole			



COX LEGEND
Cox Feeds
Fiber

Cox
CONFIDENTIAL
NOT FOR PUBLIC RELEASE

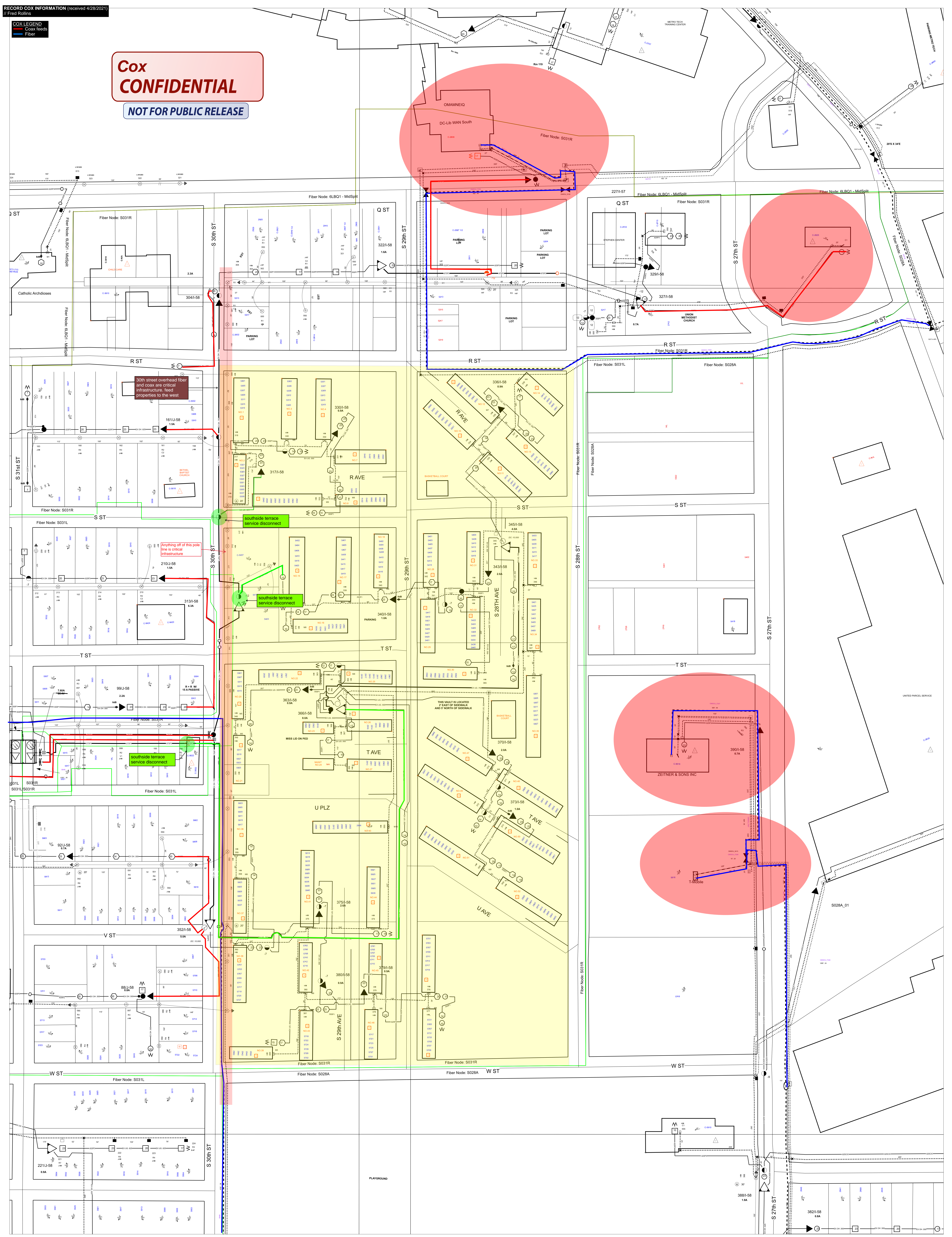

Notes:

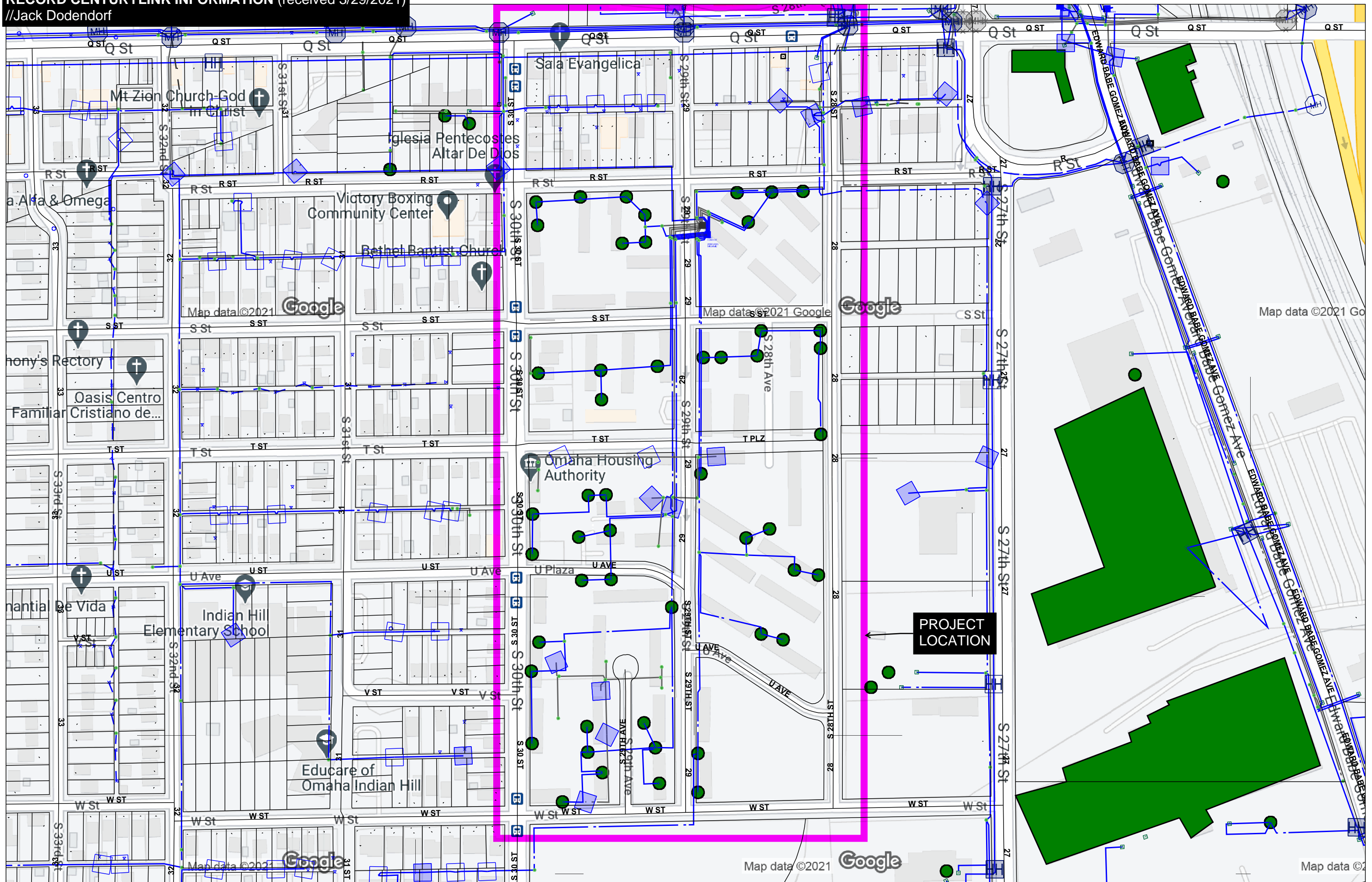

PROJECT LOCATION

RECORD CENTURYLINK INFORMATION (received 3/29/2021)
//Jack Dodendorf

SEE PAGE 182

NOTES

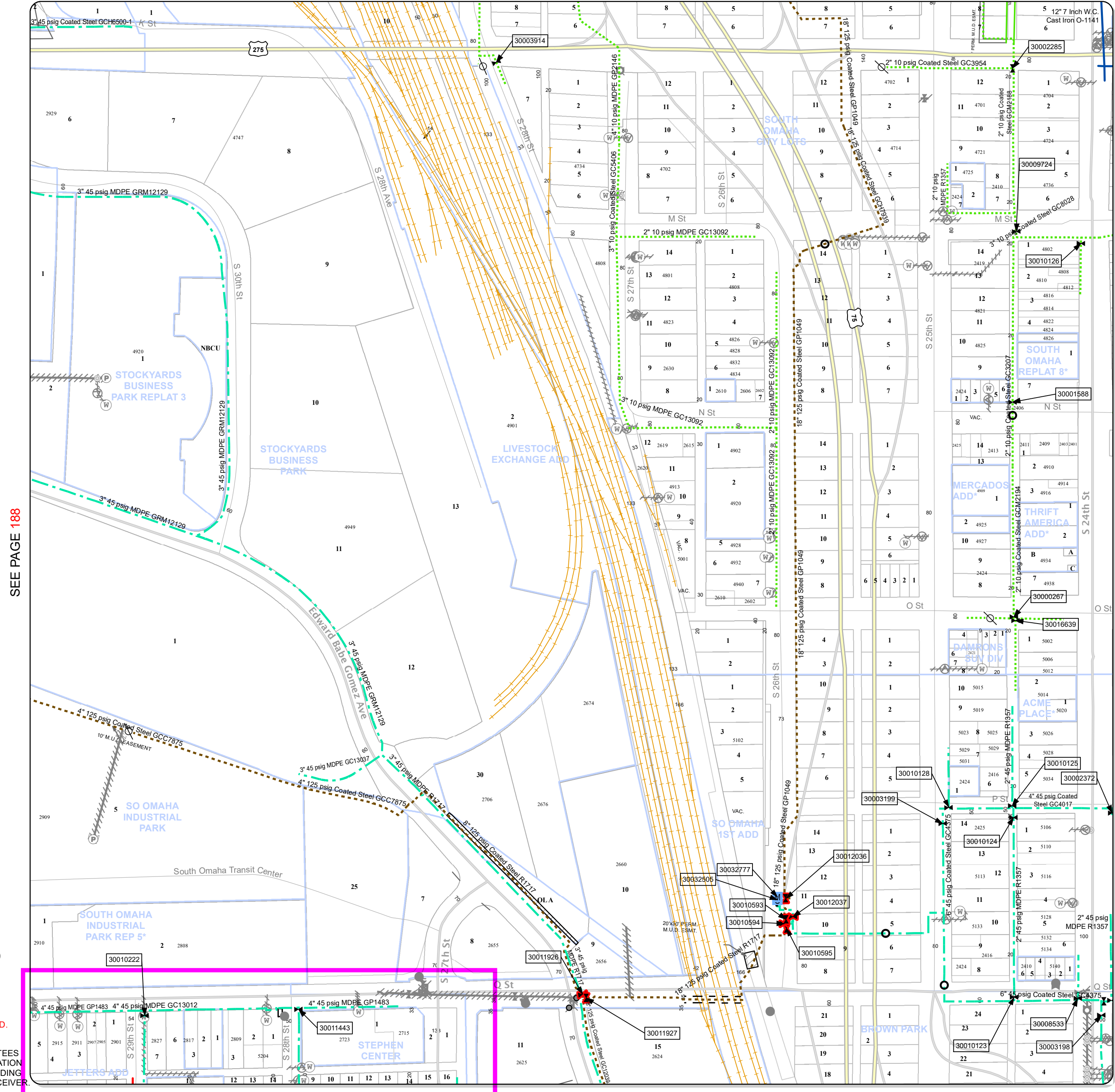

SE 1/4 SEC. 04, T. 14 N., R.13 E.
 SEWER BOUNDARY - M1
 GEOCODE - MS11WC3
 ZIP CODE - 68107

RATE JURISDICTION _____
 SEWERS _____
 TRASH _____
 SPECIAL _____
 NOTES _____

SEE PAGE 188

SEE PAGE 186

LEGEND

	wPump (P)	Valves		<all other values>
	gLowPoint		Convenience	
	gDrip		Scrubber	
	Relief Valve		Fuel Cell	
	Security Valve		Town Border Station	
	Monitoring	Main		<all other values>
	Operating		5 psig	
			10 psig	
			12 psig	
			15 psig	
			25 psig	
			45 psig	
			60 psig	
			125 psig	
			250 psig	
			360 psig	
			500 psig	
			Casing	
			wPump (A)	
		Transportation		Freeway
				Highway
				Major Road
				Minor Road
				Railroads

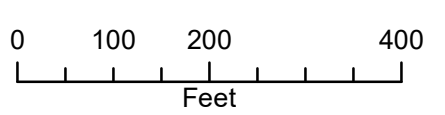

THIS PAGE IS COMPUTER GENERATED.
 MAIN SIZE SYMBOLS ARE NOT DESIGNATED.

M.U.D. MAKES NO WARRANTIES OR GUARANTEES REGARDING THE ACCURACY OF THE INFORMATION CONTAINED IN THIS DOCUMENT AND IS PROVIDING IT ONLY AS GENERAL INFORMATION TO THE RECEIVER.

PROJECT LOCATION

SEE PAGE 198

PRINTED/EXPORTED ON: Monday, March 29, 2021

SEE PAGE 181

NOTES

SW 1/4 SEC. 04, T. 14 N., R.13 E.
SEWER BOUNDARY - M1
GEOCODE - MS11WC3
ZIP CODE - 68107

RATE JURISDICTION _____
 SEWERS _____
 TRASH _____
 SPECIAL _____
 NOTES _____

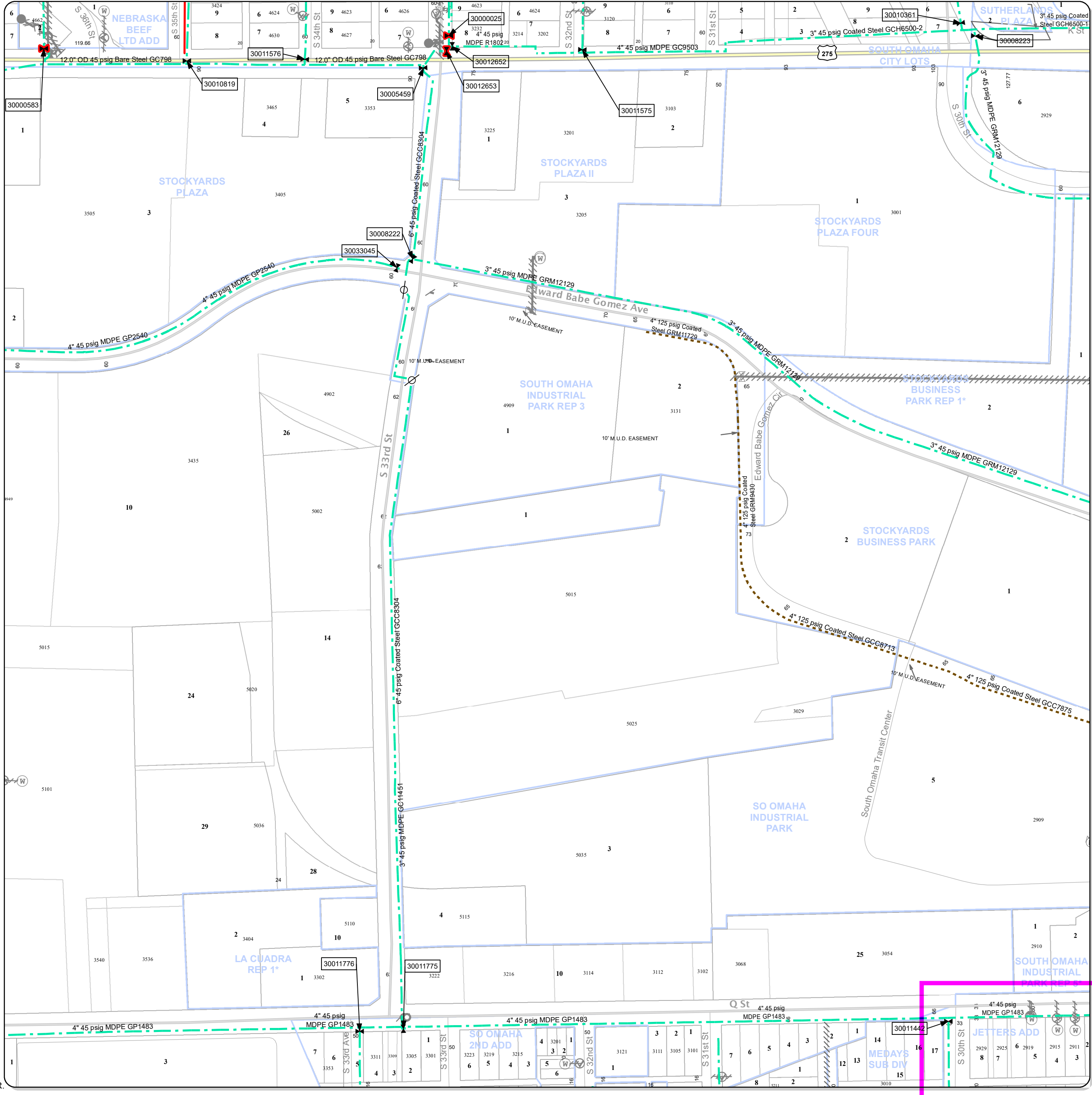

SEE PAGE 189

SEE PAGE 187

LEGEND

wPump (P)	Valves
gLowPoint	<all other values>
gDrip	Convenience
Other	Scrubber
Relief Valve	Fuel Cell
Security Valve	Town Border Station
Regulator	Main
Monitoring	<all other values>
Operating	7 Inch W.C.
	5 psig
	10 psig
	12 psig
	15 psig
	25 psig
	45 psig
	60 psig
	125 psig
	250 psig
	360 psig
	500 psig
	Casing
	wPump (A)
	Transportation
	Freeway
	Highway
	Major Road
	Minor Road
	Railroads

THIS PAGE IS COMPUTER GENERATED. MAIN SIZE SYMBOLS ARE NOT DESIGNATED.

M.U.D. MAKES NO WARRANTIES OR GUARANTEES REGARDING THE ACCURACY OF THE INFORMATION CONTAINED IN THIS DOCUMENT AND IS PROVIDING IT ONLY AS GENERAL INFORMATION TO THE RECEIVER.

SEE PAGE 197

PROJECT LOCATION

PRINTED/EXPORTED ON: Monday, March 29, 2021

SEE PAGE 188

NOTES

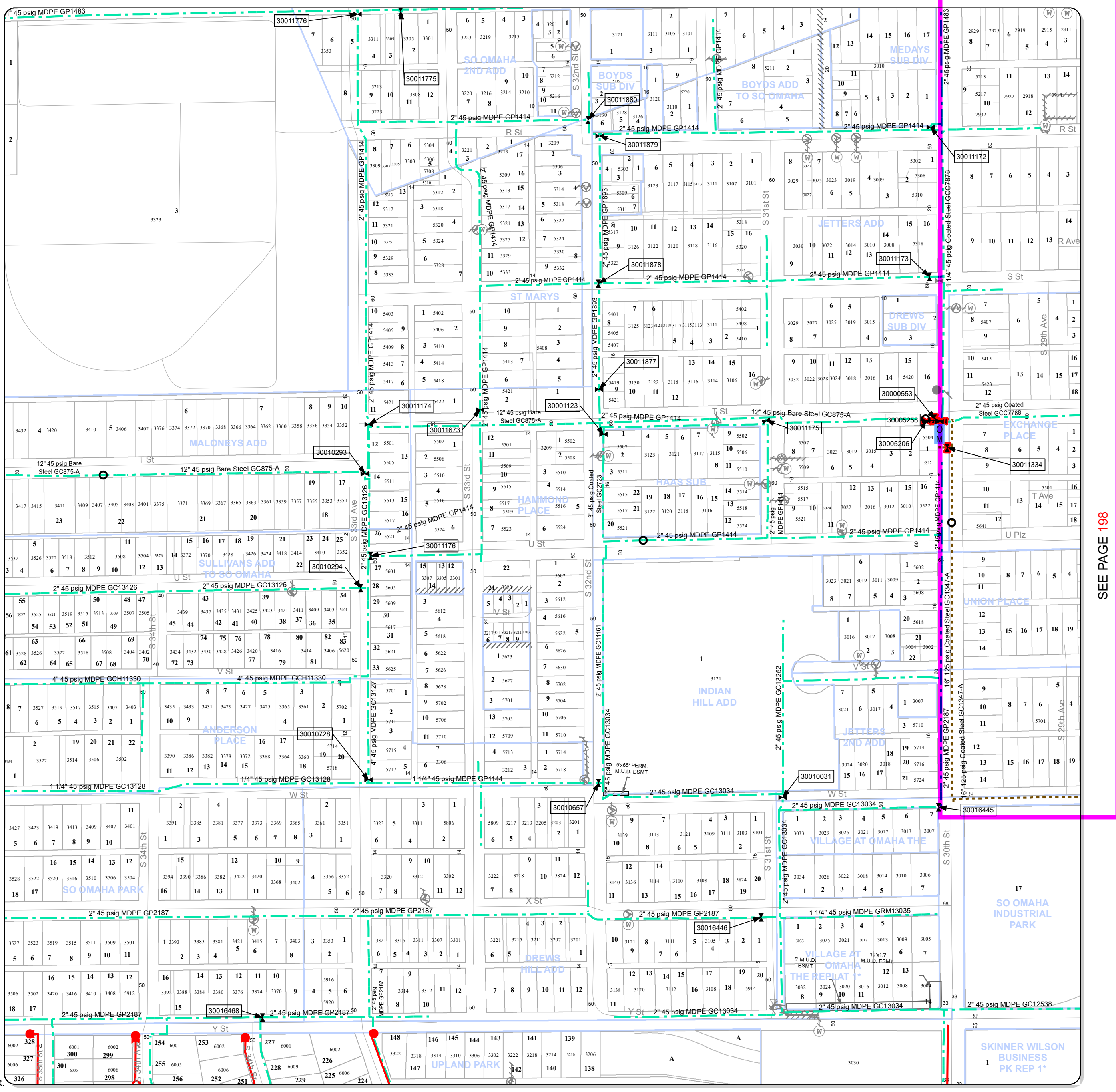

NW 1/4 SEC. 09, T. 14 N., R.13 E.
SEWER BOUNDARY - M1
GEOCODE - MS11WC2
ZIP CODE - 68107

RATE JURISDICTION _____
 SEWERS _____
 TRASH _____
 SPECIAL _____
 NOTES _____

PROJECT LOCATION

SEE PAGE 196

SEE PAGE 198

LEGEND

	wPump (P)		Valves
	gLowPoint		<all other values>
	gDrip		Convenience
	Relief Valve		Scrubber
	Security Valve		Fuel Cell
	Town Border Station		Main
	Monitoring		<all other values>
	Operating		7 Inch W.C.
			5 psig
			10 psig
			12 psig
			15 psig
			25 psig
			45 psig
			60 psig
			125 psig
			250 psig
			360 psig
			500 psig
	Casing		wPump (A)
	Freeway		Transportation
	Highway		Major Road
	Minor Road		Railroads

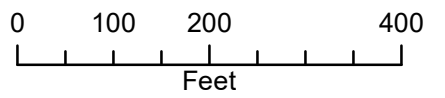
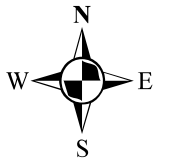

THIS PAGE IS COMPUTER GENERATED.
 MAIN SIZE SYMBOLS ARE NOT DESIGNATED.

M.U.D. MAKES NO WARRANTIES OR GUARANTEES REGARDING THE ACCURACY OF THE INFORMATION CONTAINED IN THIS DOCUMENT AND IS PROVIDING IT ONLY AS GENERAL INFORMATION TO THE RECEIVER.

SEE PAGE 204

PRINTED/EXPORTED ON: Monday, March 29, 2021

SEE PAGE 187

NOTES

NE 1/4 SEC. 09, T. 14 N., R.13 E.
SEWER BOUNDARY - M1
GEOCODE - MS11WC2
ZIP CODE - 68107

RATE JURISDICTION _____
SEWERS _____
TRASH _____
SPECIAL _____
NOTES _____

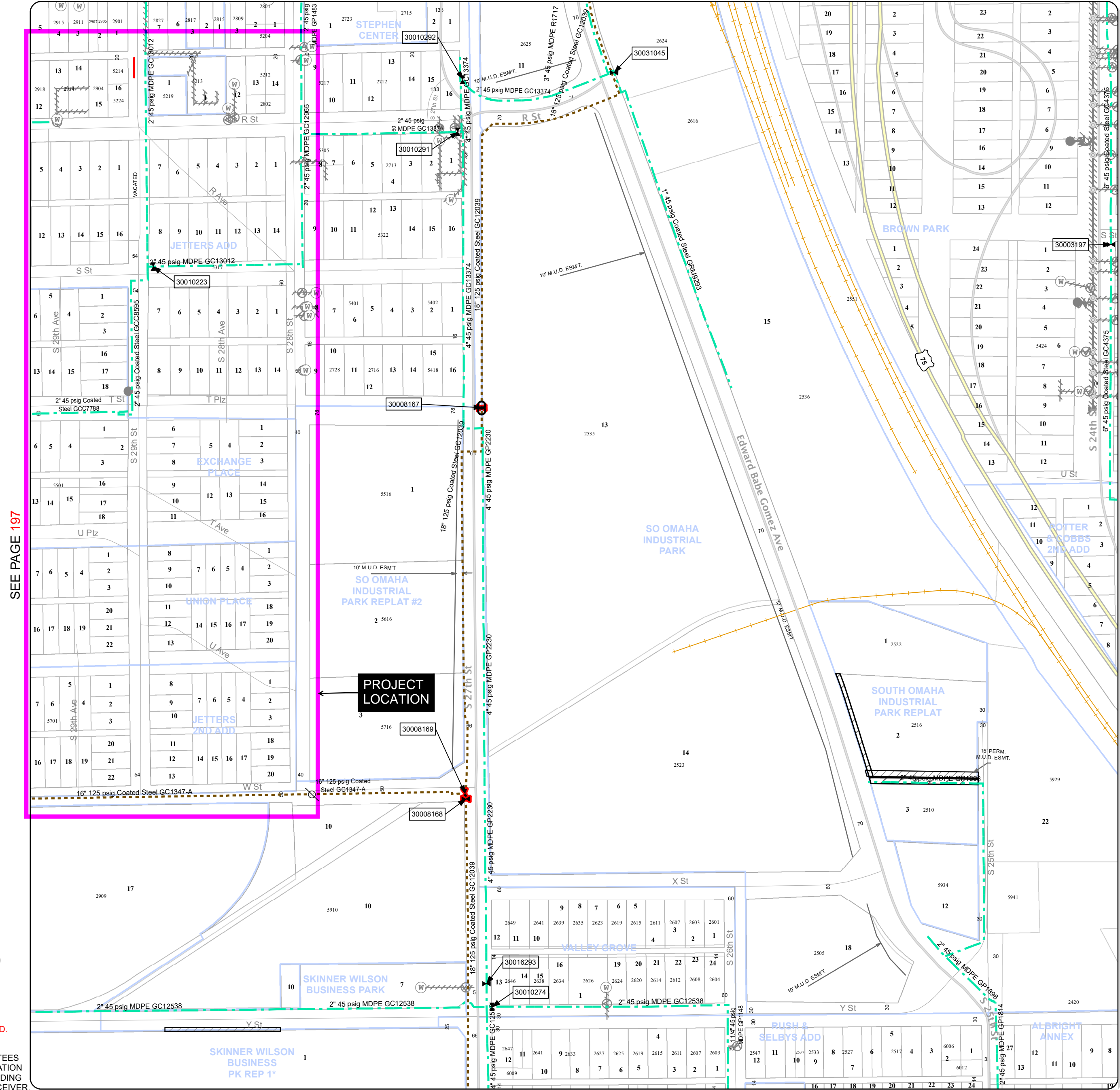

SEE PAGE 197

SEE PAGE 199

LEGEND

wPump (P)	Valves
gLowPoint	<all other valves>
gDrip	Convenience
Other	Scrubber
Relief Valve	Fuel Cell
Security Valve	Town Border Station
Regulator	Main
Monitoring	<all other values>
Operating	5 psig
	10 psig
	12 psig
	15 psig
	25 psig
	45 psig
	60 psig
	125 psig
	250 psig
	360 psig
	500 psig
	Casing
	wPump (A)
	Transportation
	Freeway
	Highway
	Major Road
	Minor Road
	Railroads

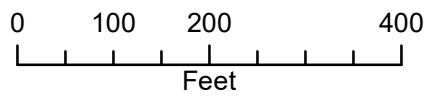

THIS PAGE IS COMPUTER GENERATED.
MAIN SIZE SYMBOLS ARE NOT DESIGNATED.

M.U.D. MAKES NO WARRANTIES OR GUARANTEES REGARDING THE ACCURACY OF THE INFORMATION CONTAINED IN THIS DOCUMENT AND IS PROVIDING IT ONLY AS GENERAL INFORMATION TO THE RECEIVER.

SEE PAGE 203

PRINTED/EXPORTED ON: Monday, March 29, 2021

NOTES

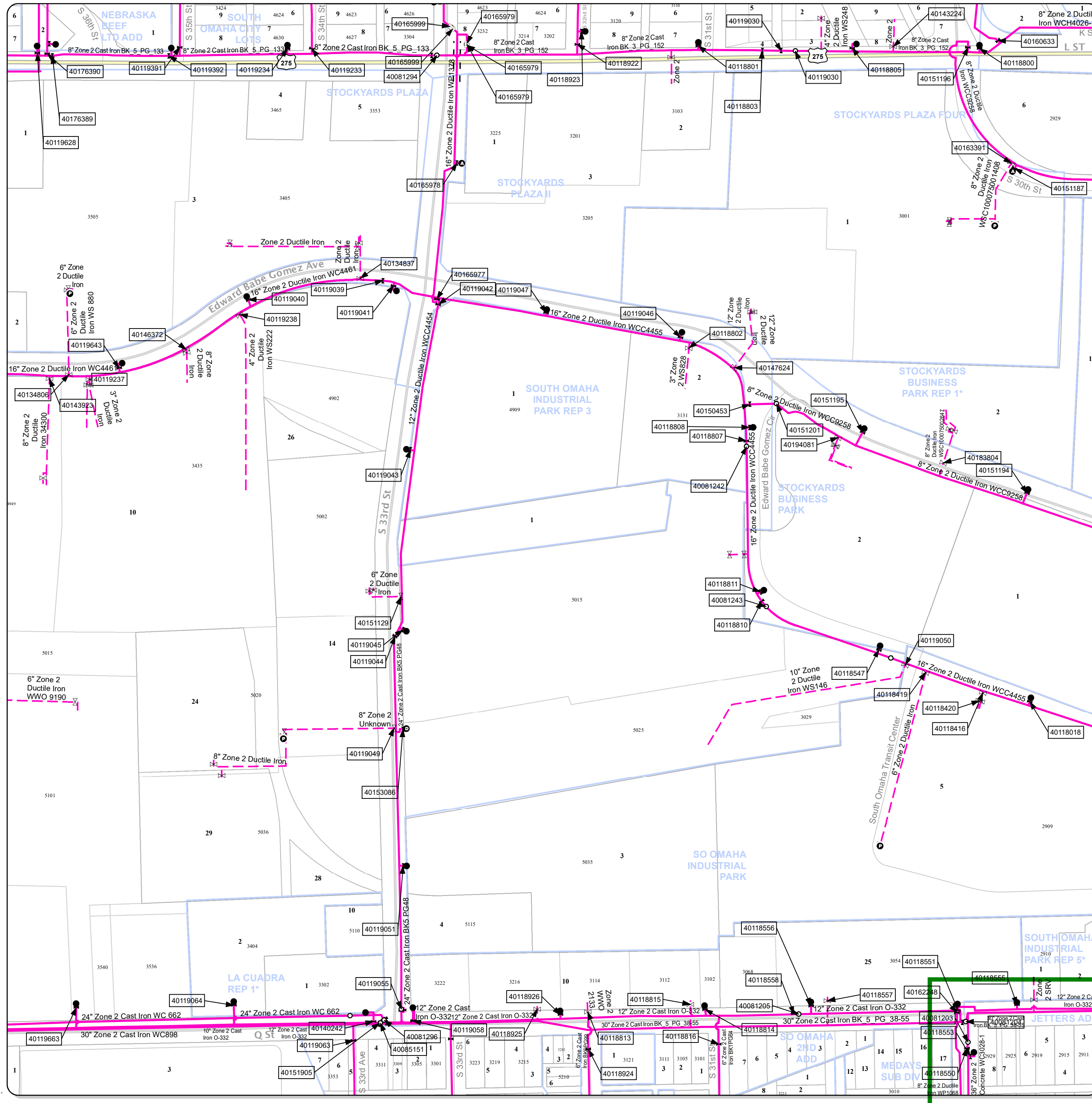

SW 1/4 SEC. 04, T. 14 N., R.13 E.
 SEWER BOUNDARY - M1
 GEOCODE - MS11WC3
 ZIP CODE - 68107

RATE JURISDICTION _____
 SEWERS _____
 TRASH _____
 SPECIAL _____
 NOTES _____

LEGEND

Main	SystemValve
— <all other values>	⊕ <all other values>
— Bennington	⊕ Right
— Millard	⊕ Left
— Schneckloth	⊕ Not Applicable
— Gibson Road	⊕ Unknown
— Elkhorn PRV	ReliefValve
— Waterloo	○ Manual Air Tap
— Ralston PRV Assist	⊕ Automatic Air Release
— Platte West Transfer	⊕ Combo Air/Vac
— Zone 1	⊕ Vacuum
— Zone 2	⊕ Surge Tank
— Zone 3	⊕ Other
Main (Raw/Sludge)	⊕ Unknown
— Raw	ControlValve
— Sludge	⊕ Altitude
Casing	⊕ Check
— Casing	⊕ Pressure Reducing
MajorServiceLine	⊕ Pressure Sustaining
— <all other values>	⊕ Pressure Relief
— Bennington	⊕ Other
— Millard	⊕ Unknown
— Schneckloth	Hydrant
— Gibson Road	⊕ Flush
— Elkhorn PRV	⊕ Air
— Waterloo	⊕ Drain
— Ralston PRV Assist	⊕ Fire
— Platte West Transfer	Tap
— Zone 1	⊕ Pitot
— Zone 2	Storage
— Zone 3	⊕ Clear Well
Freeways & Highways	⊕ Reservoir
— Freeway	⊕ Water Tower
— Highway	Well
Major Roads	⊕ Well
— Major Road	⊕ Hydrant (Private)
Minor Roads	⊕ Fire
— Minor Road	⊕ Flush
Railroads	⊕ MajorServiceValve
— Railroads	⊕ MajorServiceValve

SEE PAGE 189

SEE PAGE 187

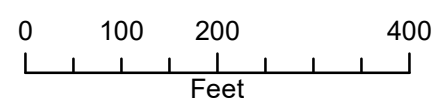

THIS PAGE IS COMPUTER GENERATED.
 MAIN SIZE SYMBOLS ARE NOT DESIGNATED.

M.U.D. MAKES NO WARRANTIES OR GUARANTEES REGARDING THE ACCURACY OF THE INFORMATION CONTAINED IN THIS DOCUMENT AND IS PROVIDING IT ONLY AS GENERAL INFORMATION TO THE RECEIVER.

PROJECT LOCATION

PROJECT LOCATION

SEE PAGE 188

NOTES

NW 1/4 SEC. 09, T. 14 N., R. 13 E.
SEWER BOUNDARY - M1
GEOCODE - MS11WC2
ZIP CODE - 68107

RATE JURISDICTION _____
SEWERS _____
TRASH _____
SPECIAL _____
NOTES _____

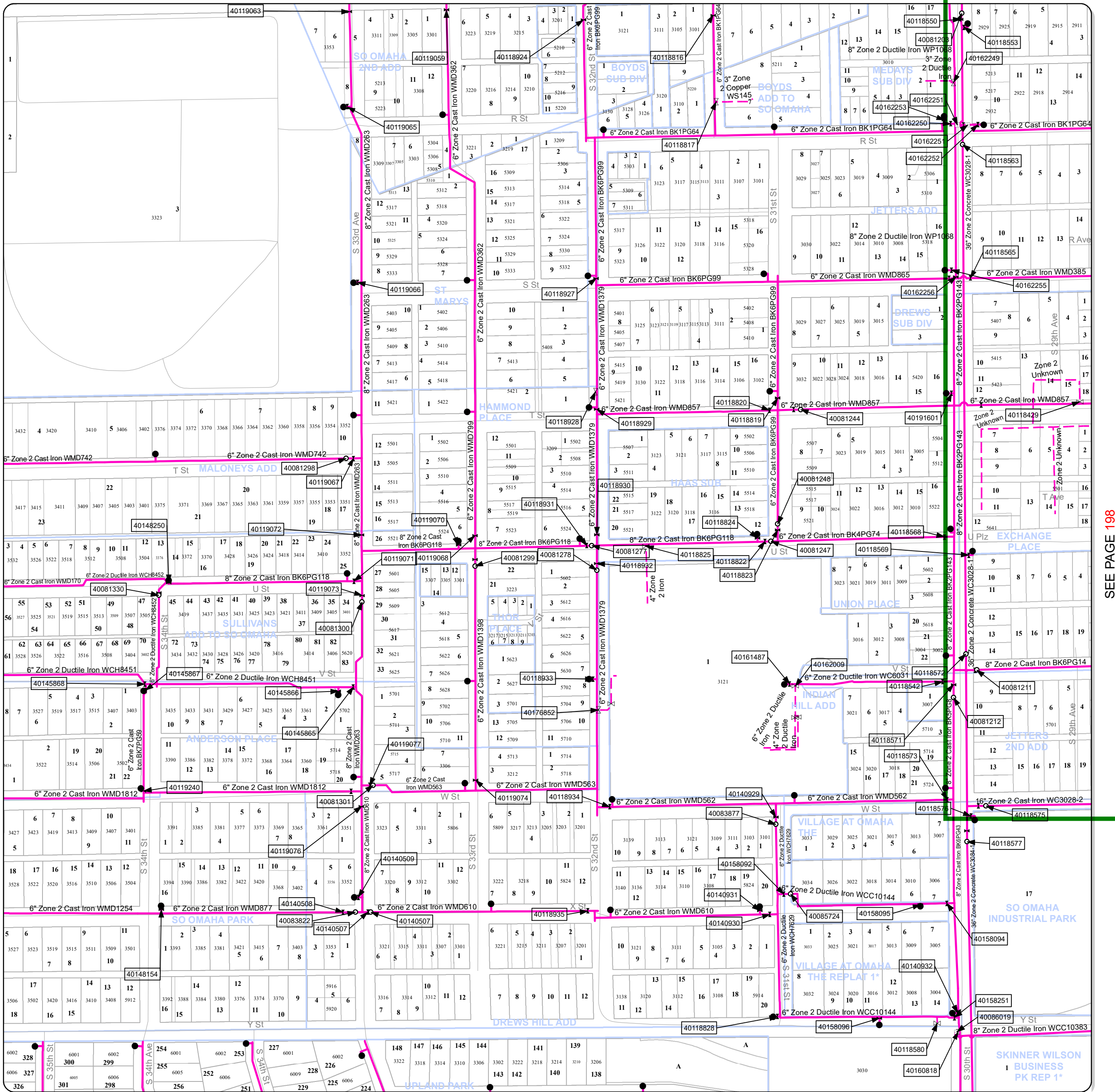

SEE PAGE 196

SEE PAGE 198

LEGEND

- | | |
|--------------------------------|-------------------------|
| Main | SystemValve |
| — <all other values> | — <all other values> |
| — Bennington | — Right |
| — Millard | — Left |
| — Schneckloth | — Not Applicable |
| — Gibson Road | — Unknown |
| — Elkhorn PRV | |
| — Waterloo | ReliefValve |
| — Ralston PRV Assist | ○ Manual Air Tap |
| — Platte West Transfer | ⊠ Automatic Air Release |
| — Zone 1 | ⊠ Combo Air/Vac |
| — Zone 2 | ⊠ Vacuum |
| — Zone 3 | ⊠ Surge Tank |
| | ⊠ Other |
| | ⊠ Unknown |
| Main (Raw/Sludge) | ControlValve |
| — Raw | ⊠ Altitude |
| — Sludge | ⊠ Check |
| | ⊠ Pressure Reducing |
| Casing | ⊠ Pressure Sustaining |
| — Casing | ⊠ Pressure Relief |
| MajorServiceLine | ⊠ Other |
| — <all other values> | ⊠ Unknown |
| — Bennington | Hydrant |
| — Millard | ⊠ Flush |
| — Schneckloth | ⊠ Air |
| — Gibson Road | ⊠ Drain |
| — Elkhorn PRV | ⊠ Fire |
| — Ralston PRV Assist | |
| — Platte West Transfer | Tap |
| — Zone 1 | ⊠ Pitot |
| — Zone 2 | |
| — Zone 3 | Storage |
| Freeways & Highways | — Clear Well |
| — Freeway | — Reservoir |
| — Highway | — Water Tower |
| Major Roads | |
| — Major Road | Well |
| Minor Roads | ⊠ Well (Private) |
| Railroads | ⊠ Fire |
| — Railroads | ⊠ Flush |
| | ⊠ MajorServiceValve |

THIS PAGE IS COMPUTER GENERATED.
MAIN SIZE SYMBOLS ARE NOT DESIGNATED.

M.U.D. MAKES NO WARRANTIES OR GUARANTEES REGARDING THE ACCURACY OF THE INFORMATION CONTAINED IN THIS DOCUMENT AND IS PROVIDING IT ONLY AS GENERAL INFORMATION TO THE RECEIVER.

SEE PAGE 204

PRINTED/EXPORTED ON: Monday, March 29, 2021

SEE PAGE 187

NOTES

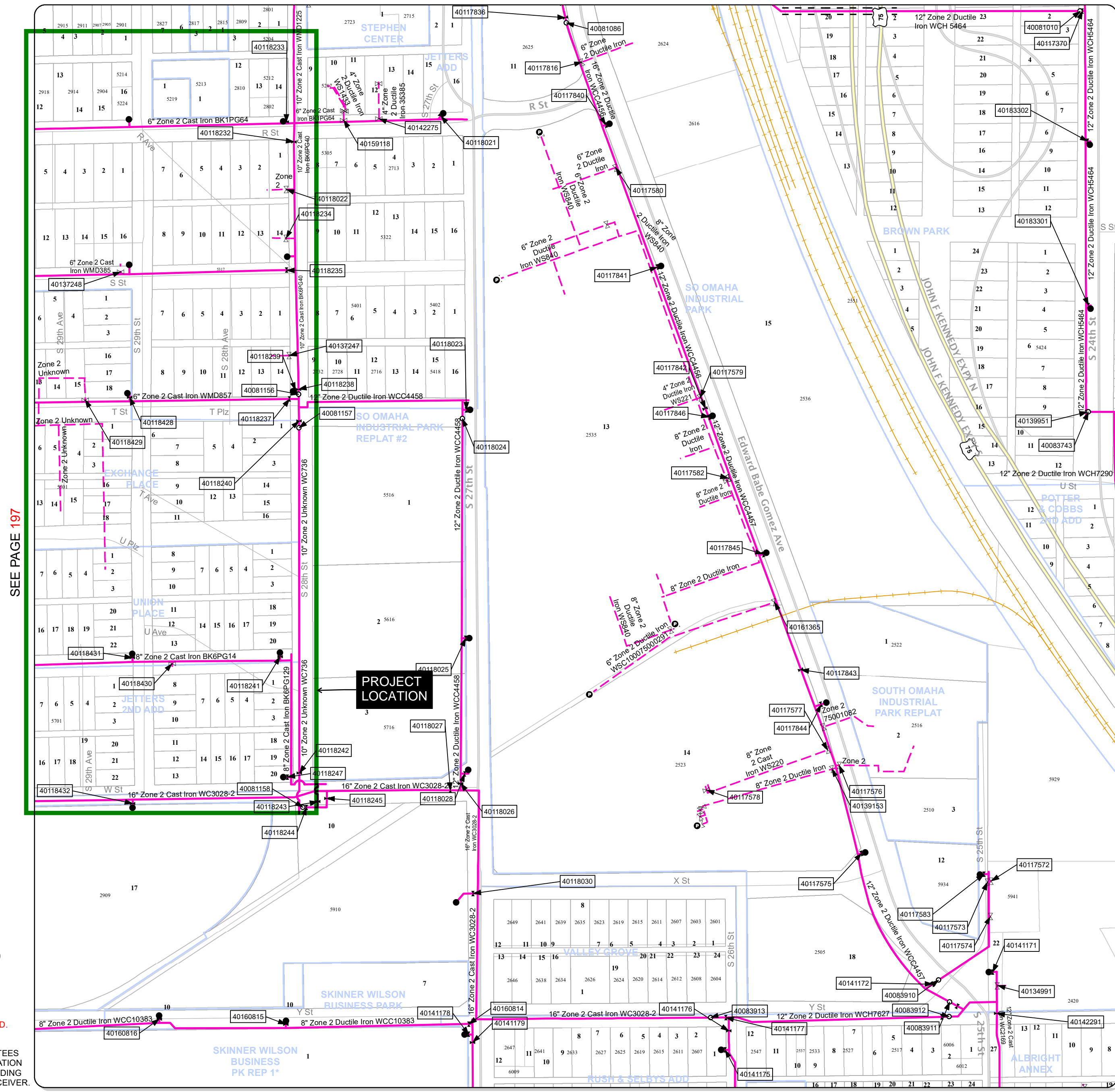

NE 1/4 SEC. 09, T. 14 N., R.13 E.
 SEWER BOUNDARY - M1
 GEOCODE - MS11WC2
 ZIP CODE - 68107

RATE JURISDICTION _____
 SEWERS _____
 TRASH _____
 SPECIAL _____
 NOTES _____

LEGEND

Main	SystemValve
- <all other values>	⊕ <all other values>
— Bennington	↔ Right
— Millard	↔ Left
— Schneckloth	⊕ Not Applicable
— Gibson Road	⊕ Unknown
— Elkhorn PRV	
— Waterloo	ReliefValve
— Ralston PRV Assist	○ Manual Air Tap
— Platte West Transfer	⊕ Automatic Air Release
— Zone 1	⊕ Combo Air/Vac
— Zone 2	⊕ Vacuum
— Zone 3	⊕ Surge Tank
	⊕ Other
	⊕ Unknown
Main (Raw/Sludge)	ControlValve
— Raw	⊕ Altitude
— Sludge	⊕ Check
	⊕ Pressure Reducing
Casing	⊕ Pressure Sustaining
— Casing	⊕ Pressure Relief
MajorServiceLine	⊕ Other
— <all other values>	⊕ Unknown
— Bennington	Hydrant
— Millard	⊕ Flush
— Schneckloth	⊕ Air
— Gibson Road	⊕ Waterloo
— Elkhorn PRV	⊕ Ralston PRV Assist
— Waterloo	⊕ Platte West Transfer
— Ralston PRV Assist	— Zone 1
— Platte West Transfer	— Zone 2
— Zone 1	— Zone 3
— Zone 2	Tap
— Zone 3	⊕ Pitot
Freeways & Highways	Storage
— Freeway	⊕ Clear Well
— Highway	⊕ Reservoir
Major Roads	⊕ Water Tower
— Major Road	Well
Minor Roads	⊕ Well (Private)
— Minor Road	⊕ Fire
Railroads	⊕ Flush
— Railroads	⊕ MajorServiceValve

SEE PAGE 197

SEE PAGE 199

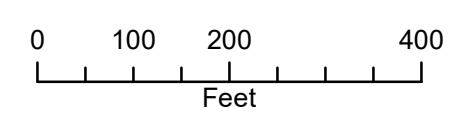

THIS PAGE IS COMPUTER GENERATED.
 MAIN SIZE SYMBOLS ARE NOT DESIGNATED.

M.U.D. MAKES NO WARRANTIES OR GUARANTEES REGARDING THE ACCURACY OF THE INFORMATION CONTAINED IN THIS DOCUMENT AND IS PROVIDING IT ONLY AS GENERAL INFORMATION TO THE RECEIVER.

SEE PAGE 203

PRINTED/EXPORTED ON: Monday, March 29, 2021

//James Gould

Rob Vanderveen

From: GOULD, JAMES A <jagould@oppd.com>
 Sent: Monday, April 5, 2021 12:39 PM
 To: Rob Vanderveen
 Cc: Joe P. Zadina; Mainor Martinez
 Subject: RE: Southside Terrace

[EXTERNAL EMAIL]

Green is underground, Orange is overhead and Yellow are our wood poles.

OPPD LEGEND

- Underground Power
- Overhead Power
- Wood Poles

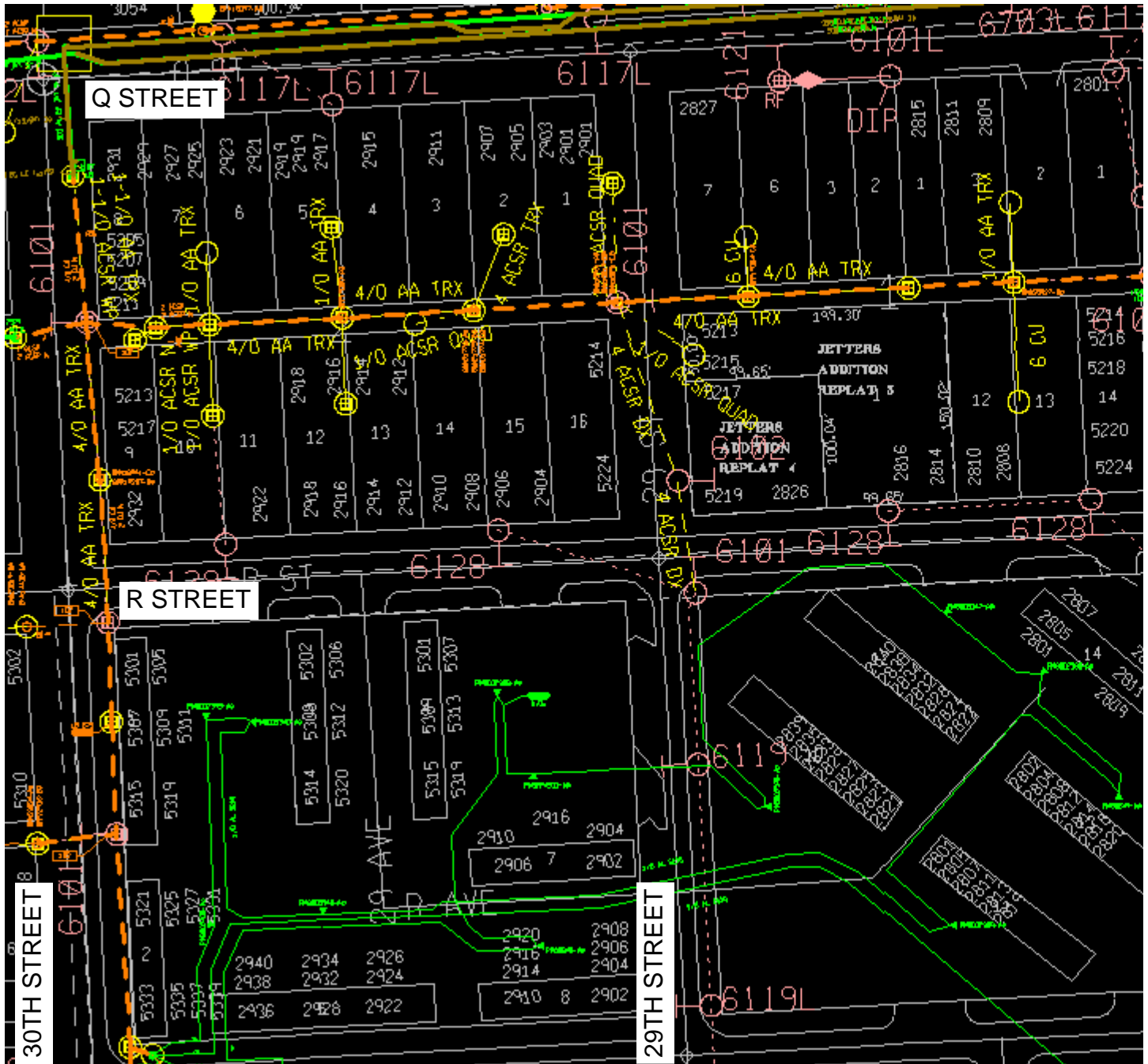

Q to S

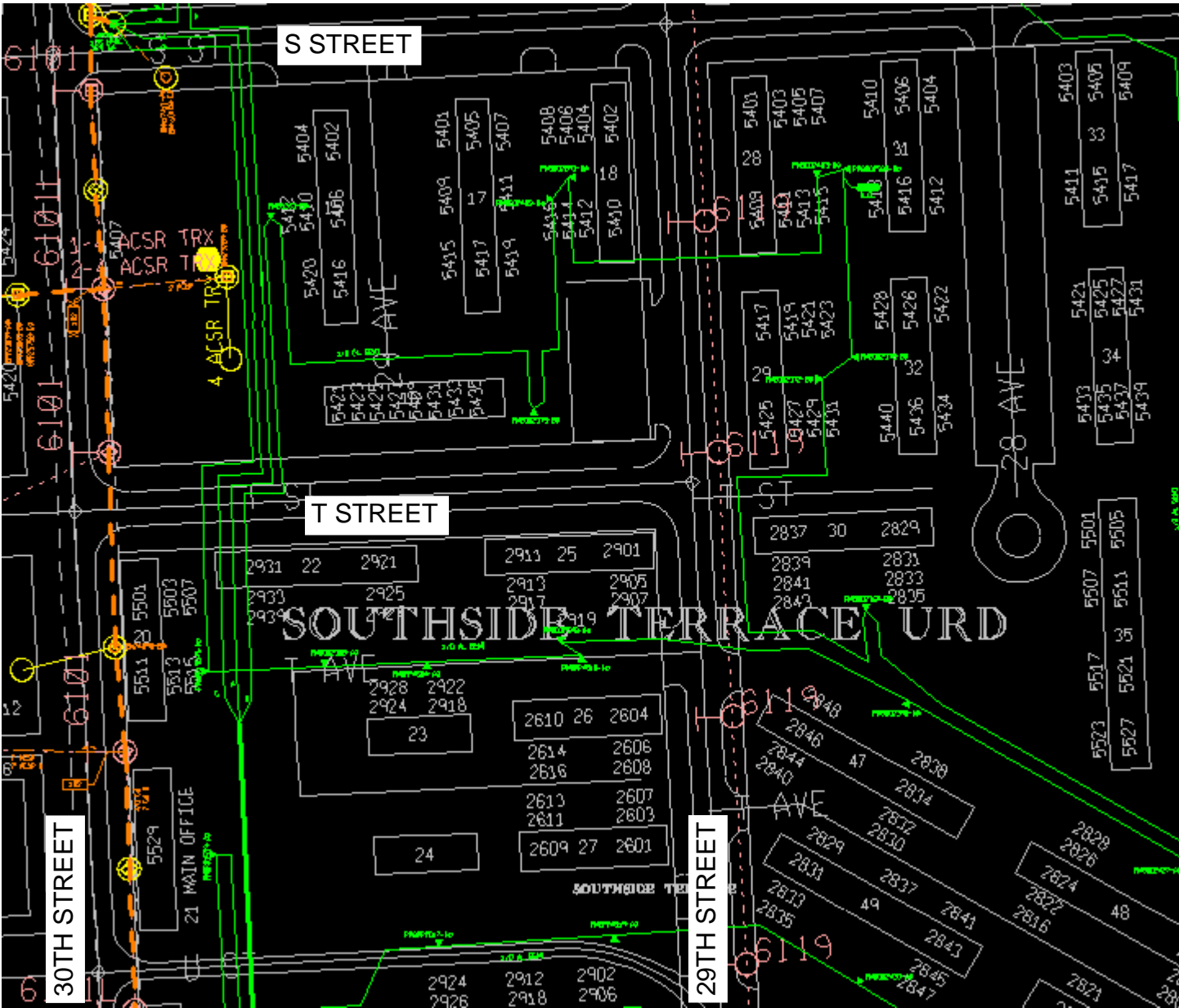

S to U

OPPD LEGEND

- Underground Power
- Overhead Power
- Wood Poles

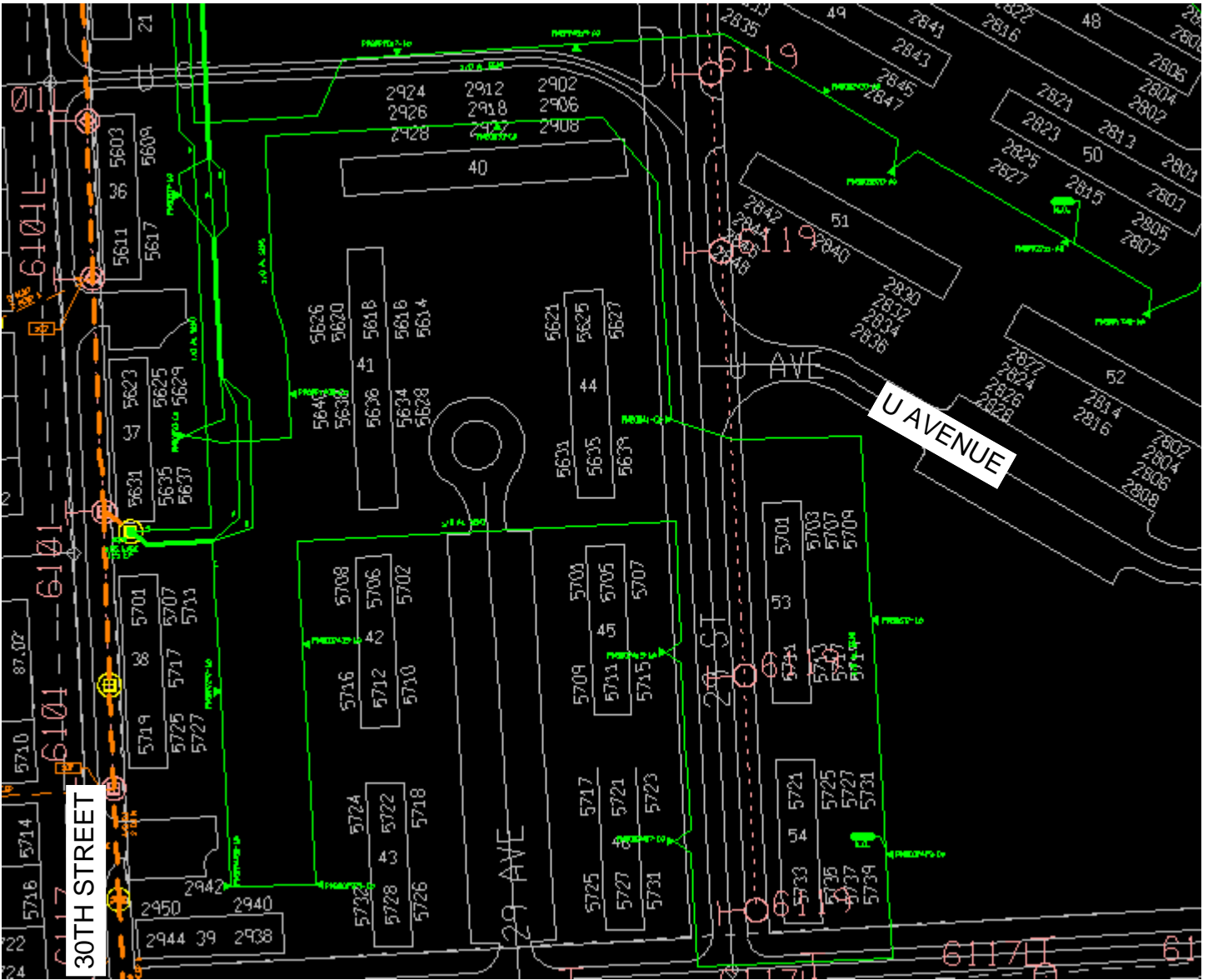

U to W

OPPD LEGEND

- Underground Power
- Overhead Power
- Wood Poles

From: Rob Vanderveen <Rob.Vanderveen@LampRynearson.com>
Sent: Monday, March 29, 2021 11:57 AM
To: GOULD, JAMES A <jagould@oppd.com>
Cc: Joe P. Zadina <Joe.Zadina@LampRynearson.com>; Mainor Martinez <Mainor.Martinez@LampRynearson.com>
Subject: Southside Terrace

READ THIS FIRST! This is **NOT** an OPPD email.
 Be very cautious of any links or attachments unless you recognize this sender -
rob.vanderveen@lamprynearson.com and are expecting this email.
Please click the "Report it" button if you think this email is malicious.

James – We are in the middle of an existing infrastructure analysis on a large redevelopment project in South Omaha.

The project is a large re-development of existing public housing and is bounded on the north by Q street, the west by 30th Street, the east by 27th Street, and the south by W Street. The project will involve re-platting and re-routing of public streets throughout. The finished product will be a large multi-income and multi-use (though primarily residential) development. Something similar to Highlander in North Omaha.

TRANSMISSION LINE INFORMATION

continue north
along 27th



continue south
along 30th

Google





Registered Tower Detail - Tower (1)



Ownership Info

Rep	Company: Fletcher, Heald & Hildreth, PLC Contact: Francisco R Montero Esq Phone: (703)812-0400 Email: montero@fhlaw.com	Address: 1300 N. 17th Street Arlington, VA, 22209
Owner	Company: SummitMedia, LLC Contact: Not Recorded Phone: (205)322-2987 Email: darryl.grondines@summitmediacorp.com	Address: 2700 Corporate Drive Birmingham, AL, 35242

Tower Characteristics

Registration #:	1036753	Ground Elev:	1123.1 feet
Latitude:	41.2011	Height Of Structure:	442.9 feet
Longitude:	-95.9536	Overall Height:	1573.2 feet
Structure Type:	NA	Structure Address:	5616 SOUTH 27TH STREET OMAHA, NE
Status:	Constructed		
Date Constructed:	01/01/1994		

History

Purpose	Status	Date	Addnl Info
New Reg	Granted	01/26/1998	---
Adm Update	Granted	06/01/2009	---
Adm Update	Granted	04/01/2014	---
Owner Change	Granted	02/11/2016	Rep Owner Baker & Hostetler LLP Scripps Broadcasting Holdings LLC
Modification	Granted	11/06/2017	---
Constructed	Granted	11/06/2017	---
Owner Change	Granted	12/19/2018	Rep Owner Fletcher, Heald & Hildreth, PLC SummitMedia, LLC